



# FLOOR DRAIN TECHNOLOGY

Solid | Hygienic | Robust | Durable

Kagetec Drains exclusively by



German Engineering - American Sales and Service

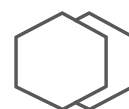

**KAGETEC**<sup>®</sup>  
drain technology

**Industrial floor drain**  
single-part DRS-S

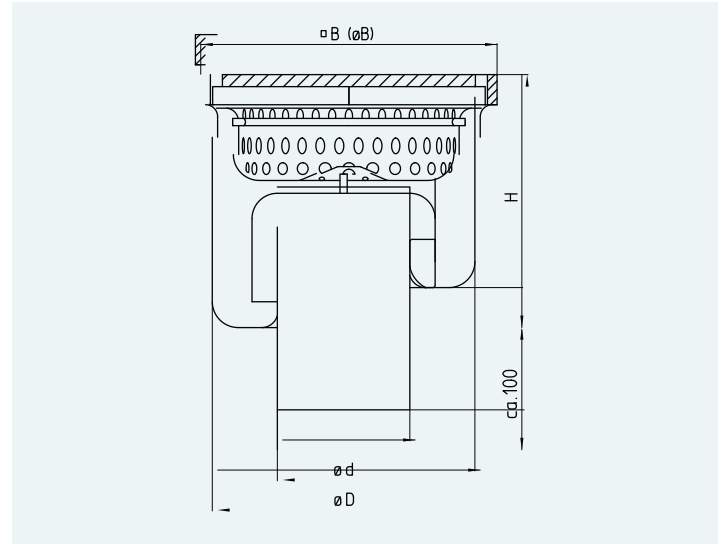

Model	Ø d [mm]	∇ B [mm]	Ø D [mm]	H [mm]	Silt box volume [l]	Flow rate [l/s]
DRS-070-E-S	75 (3 ")	180 (7 1/6")	6"   153	5"   127	0.5 (.13 gal)	>1.5 (23.78 gpm)
DRS-100-E-S	110 (4 ")	246 (9 11/16")	8 9/16"   218	8 1/4"   210	1.5 (.396 gal)	> 2.8 (44.38 gpm)
DRS-150-E-S	160 (6")	310 (12 3/16")	11 1/8"   283	9 13/16"   250	2.75 (.75 gal)	> 8.2 (129.97 gpm)
DRS-200-E-S	200 (8 ")	410 (16 1/8")	14"   356	12 3/8"   315	6 (1.59 gal)	> 12.5 (198.13 gpm)

**Cover variants**

■ Plate cover, M125

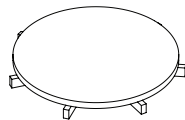
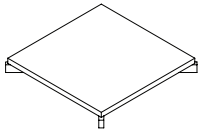

■ Bar grate cover, M125

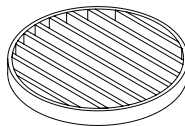
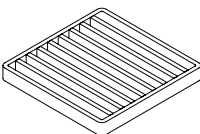

■ Grating, L15

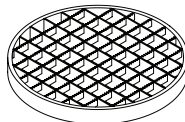
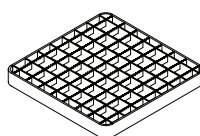

■ Plate 5 mm, not illustrated. L15

■ Plate 3 mm, hole ø 8 mm, not illustrated, K3

**Inlet rim**

■ square ■ round

**Grade**

■ 1.4301 (AISI 304) ■ 1.4571 (AISI 316 Ti)

**Square inlet rims for tiled floors**

Our square inlet rims are particularly suitable for tiled floors. The inlet rims are made of solid stainless steel, providing maximum stability to withstand forklift operations. The sharp-edged transition to the adjoining jointing or grouting material eliminates the risk of the material separating from the stainless steel. This guarantees the highest level of hygiene by avoiding cracks where bacteria can accumulate.

**Floor drains for tiled or resin floor coverings**

The floor drains are available with square inlet rims for tiled floors or with round inlet rims for synthetic resin flooring. Whether square or round – both versions have been made of solid stainless steel to provide maximum stability to withstand forklift operations. A sharp-edged transition to the adjoining jointing, grouting of flooring material prevents separation or cracks in the material. This prevents the accumulation of bacteria in cracks or joints, and by using our floor drains you ensure the highest standard of hygiene.

**Industrial channel IKR**  
with welded/underwelded channel drain

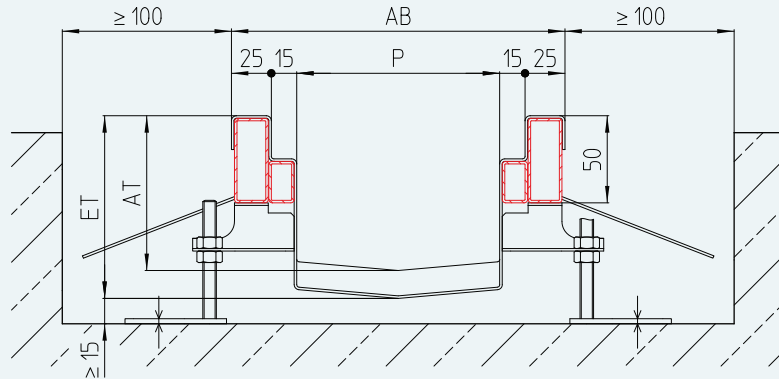

Channel model	in   P [mm]	in   AB [mm]	AT <sup>7)</sup>	Fall	ET [mm]
IKR-070-150	70 (2 3/4")	150 (5 7/8")	60 (2 3/8")	0.6 %	
IKR-090-170	90 (3 9/16")	170 (6 11/16")	60 (2 3/8")	0.6 %	
IKR-120-200	120 (4 3/4")	200 (7 7/8")	60 (2 3/8")	0.6 %	
IKR-170-250	170 (6 11/16")	250 (9 13/16")	60 (2 3/8")	0.6 %	
IKR-220-300	220 (8 11/16")	300 (11 13/16")	60 (2 3/8")	0.6 %	
IKR-320-400	320 (12 5/8")	400 (15 3/4")	60 (2 3/8")	0.6 %	
IKR-420-500	420 (16 9/16")	500 (19 11/16")	60 (2 3/8")	0.6 %	

Calculation ET:  $AT + L1 \times 0,006$  [AT; ET; L1 in mm]

**Grade**

- 1.4301 (AISI 304)
- 1.4571 (AISI 316 Ti)

**Cover variants**

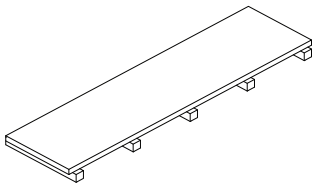

■ Plate cover M125

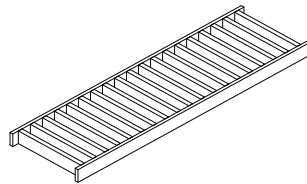

■ Bar grate cover M125

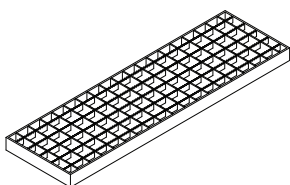

■ Grating L15

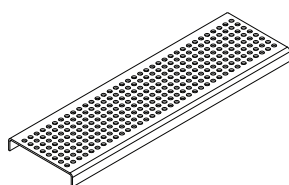

■ Plate cover; 3,0 mm K3

**Slot channels for smaller flows**

Our channels are fully visible through their slots, which means they can be examined at any time to verify their cleanliness. This ensures that they can be kept in a fully hygienic state. The slot channels are also available without spacers to facilitate cleaning and are available in various load classes.

**Channels for larger flows**

These channels are available in various widths, engineered for the volumes of water to be transported. They are also capable of acting as temporary storage for large amounts of water for short periods.

The highest variety of covers are available for all our channels. Gratings, bar grates, and plate covers are available with various anti-slip and load bearing characteristics.

# KAGETEC DRAINS BY WIEDEMANN

We have been engineering and manufacturing stainless steel floor drains for over 40 years. As early as 1951 we developed, produced and installed cast metal drain intakes for dairies. We have used this experience to further develop our floor drains, adapting them to meet the ever-increasing requirements of our global client base. Our focus is, and always has been, the hygienic needs of the food and beverage processing industry.

## Engineered Floor Drain Solutions for

Beverage industry

Meat industry

Dairy industry

Chemical and pharmaceutical industry

Commerical kitchens



**Kagetec, LLC**

612.435.7640

24631 Saint Benedict Road  
Jordan, MN 55352

info@kagetecusa.com

[www.kagetecd rains.com](http://www.kagetecd rains.com)  
[www.kagetecusa.com](http://www.kagetecusa.com)

Kagetec Drains exclusively by

